

CS09 Series 2.54mm(.100") Single in Line Adapter Strip

- Machined pin options pin length available
- Highly reliable method of board to board interconnecting

Construction-

- Insulation: PPS UL 94V-0

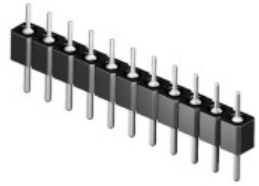

RoHS Compliant

Ordering code

① **C S 0 9** ② **4 0** ③ **2** ④ **1** ⑤ **A 0 0**

- ① Series No.
- ② Circuits: 02 to 40
- ③ Plating code: 2= Gold flash over Nickel plated
*Optional plating available but MOQ requested
- ④ Color: 1= Black
- ⑤ Other options: A00= Type A (Standard)
B00= Type B
C00= Type C
*Special options consult manufacturer

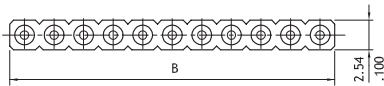

A = 2.54 * No. of Spaces
B = A + 2.44

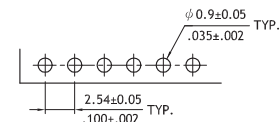
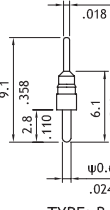
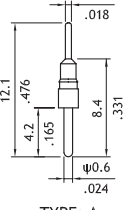
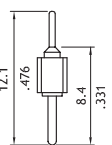
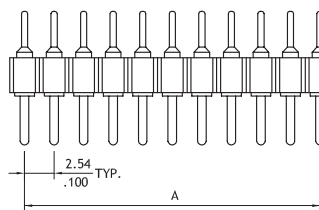

Recommended P.C. Board Layout

CS10 Series 2.54mm(.100") Single in Line SIP Socket

- High reliability screw machine terminals with multiple finger contact
- Seal and prevent flux wicking

Construction-

- Insulation: PPS UL 94V-0
- Contact: Gold plated Beryllium copper

Comet electronics Part. No M20S
Comet electronics Part. No M40S

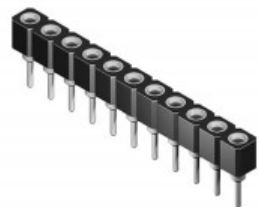

RoHS Compliant

Ordering code

① **C S 1 0** ② **4 0** ③ **D** ④ **1** ⑤ **0 0 0**

- ① Series No.
- ② Circuits: 02 to 40
- ③ Plating code: D= Tin plated sleeve
with 10µin Gold plated contact
- ④ Color: 1= Black
- ⑤ Other options: 000= Standard
*Special options Consult manufacturer

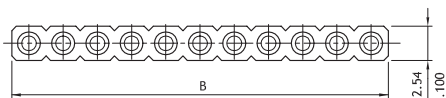

A = 2.54 * No. of Spaces
B = A + 2.44

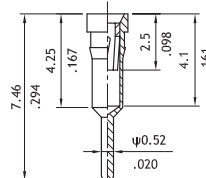
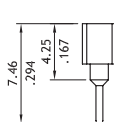
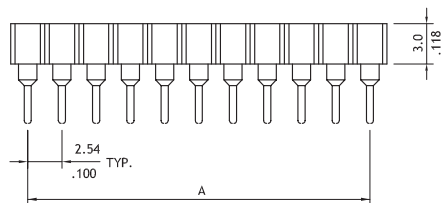

Pin detail

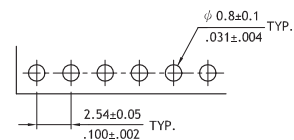

Recommended P.C. Board Layout