

Vitesse

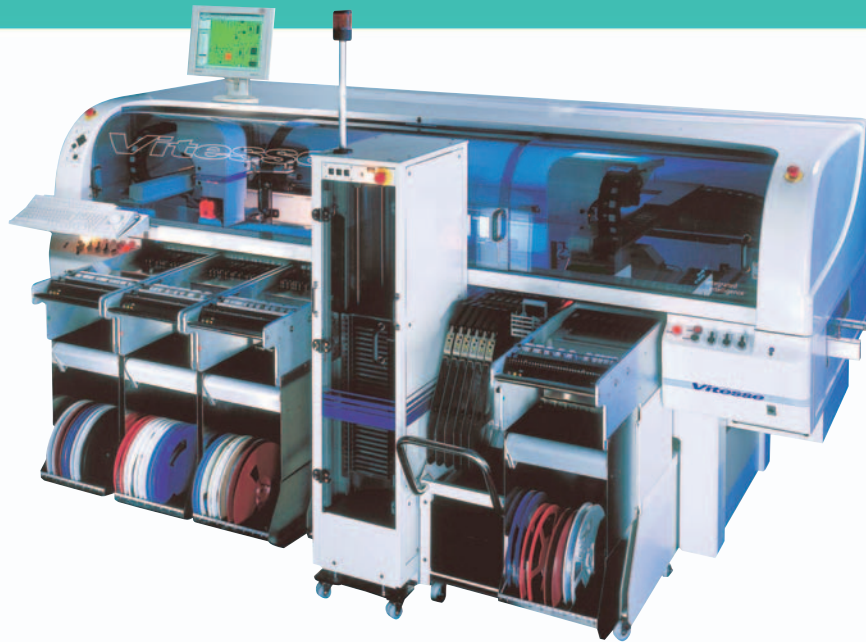

Machine Capability

Tact time	0.144 sec per chip - 25,000 c.p.h. (IPC: 20,500 c.p.h.)
Placement accuracy	standard 35 μ m (QFPs) to 60 μ m (Chips)
Pick up heads	twin rotary turret head on X/Y gantries with 8 pick ups each & 2 x 48 position 'smart' nozzle tool bank
Component analysis	'on-the-fly' grey scale vision as standard, fixed camera option
Feeder range	full range of intelligent feeders for 8 – 88mm tapes, for components in plastic sticks and matrix trays
Feeder capacity	198 x 8mm tape feeder positions

Board Handling

Length	60mm to 500mm
Width	60mm to 460mm (reduced by certain options)
Thickness	0.5mm to 4.5mm
Weight	3Kg max.
Under board clearance	25mm
Board location	full edge clamping with fiducial correction
Board edge clearance	3mm above/5mm below
Transport criteria	Left to Right (Right to Left optional), fixed front rail, height – 950mm (adjustable 890 – 975mm), SMEMA interface

Component Range

Types	chips in rectangular and cylindrical form, aluminium electrolytic capacitors in can form, SO, PLCC, QFP, TSOP, BGA, μ BGA, CSP, connectors and other odd-form surface mount devices
Minimum size	0.5mm x 0.25mm (0201)
Maximum size	50x50mm as standard, 70x70mm with fixed camera option, 100mm long connectors
Maximum height	12mm, 21mm in special single component mode using special feeder
Minimum lead pitch	0.4mm as standard, 0.3mm option

Options

- fixed camera for larger and very fine pitch (0.3mm) components, (min. pcb width: 85mm)
- feeder trolley options for bulk change of individual feeder and 'mass' tape feeder ranges
- 2 x internal fixed 10 positions zones or 30 position automatic loader for matrix trays
- PROMON Management Information Software
- electrical component verification
- automatic width adjust
- off-line intelligent feeder storage trolley
- boards and components traceability

General

Electric	400/210V three phase - 50Hz/60Hz, 5 - kVA
Air	7 bars, 20 l/min
Noise	<70dB (A)
Working temperature	range 10° - 30°C, ideally 20°C \pm 5°C
Humidity	20 – 80% RH
Weight	2200 Kg (without feeders)
Colour	Eurolacer white

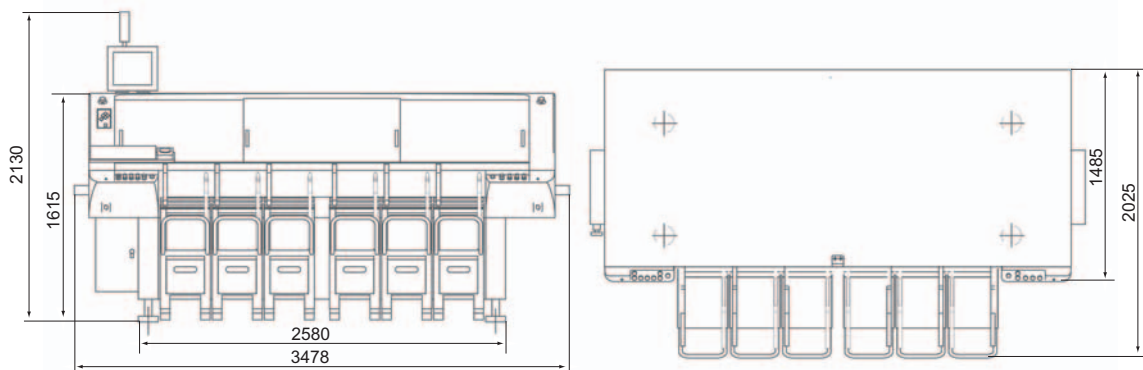

Dimensions in mm